

Create-A-Bed[®]LLC

Note: DO NOT deviate from these plans.

These plans are for constructing a

FOLD DOWN DESK

for Vertical beds only.

Maximum weight capacity for the table is 50 pounds,
please avoid heavy objects on the desk!

If you are missing any parts or have ANY
questions pertaining to materials or construction
please phone the manufacturer.

TOLL FREE 1-877-966-3852

TOOLS NEEDED:

Power Saw, Table Saw or Circular Saw
Power Drill
Driver Bits for Drill
Drill Bits
Drill Bit Extension
Tape Measure
Hammer
Clamps
Level
Household Iron For Veneer Tape and Knife

©*Create-A-Bed LLC[®] 2024*

1800 Taylor Avenue Louisville, KY 40213

www.createabed.com

TOLL FREE: 1-877-966-3852

Create-A-Bed LLC®

Fold Down Desk Mechanism

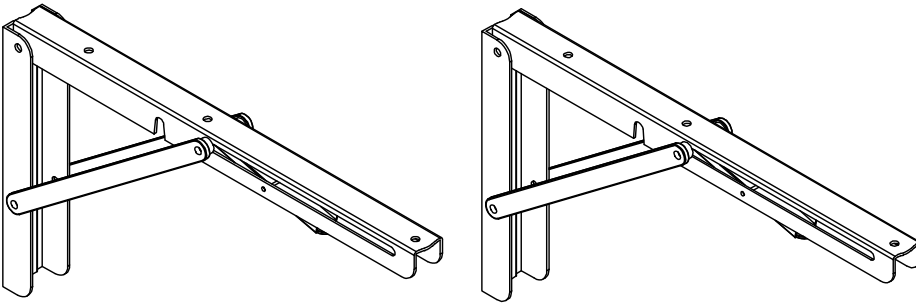

Two (2) FOLDABLE BRACKETS



Twelve (12) #12 x 3/4"
Pan Head Screws

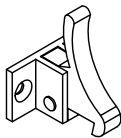

Two (2) #4 x 3/4" Pan Head Screws

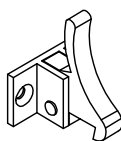

Two (2) HEAVY DUTY LATCHES with CATCH

Four (4) #4 x 3/4" Screws

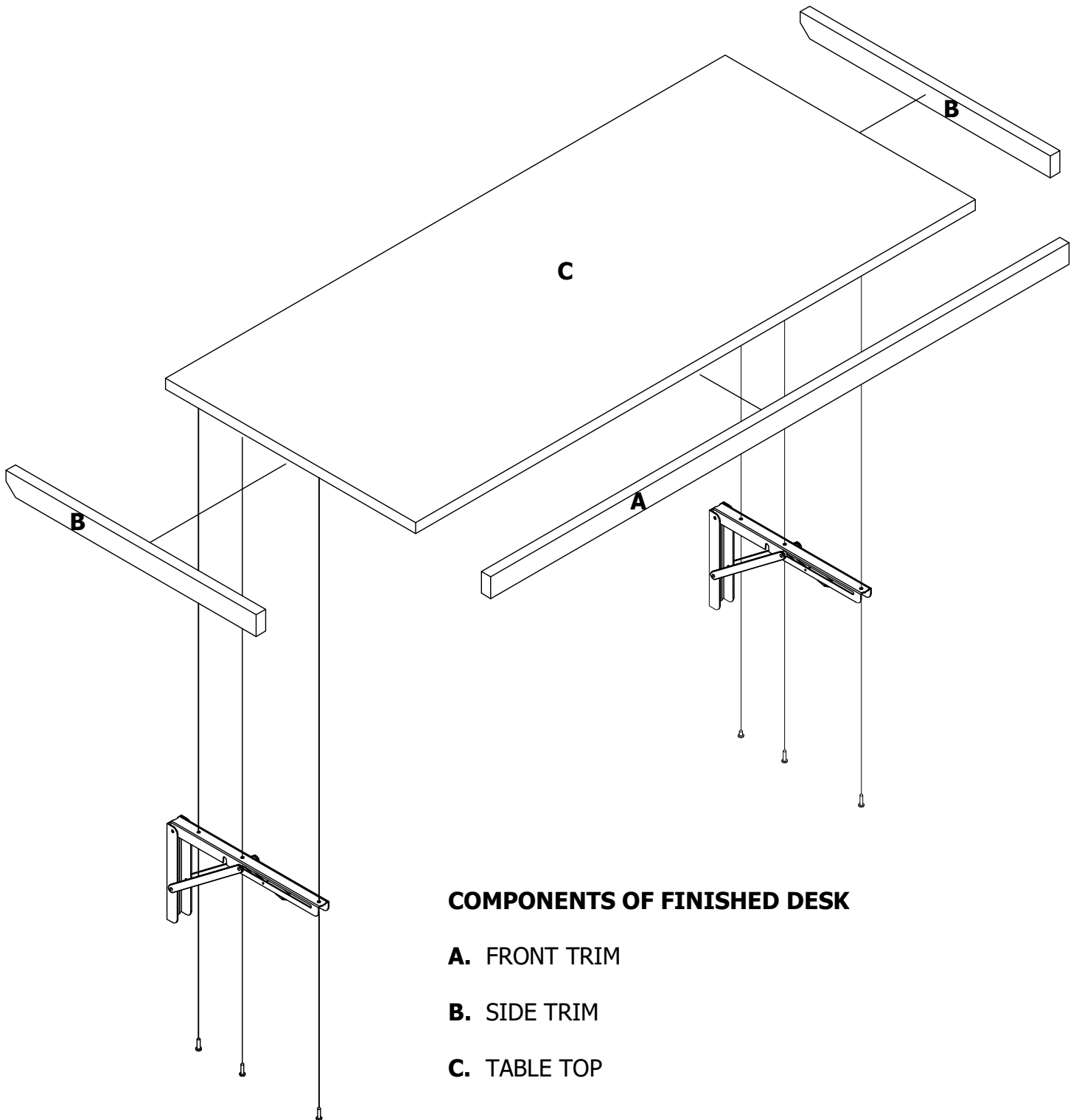

Bill of Materials / Cut Sheet

___ Check off as completed

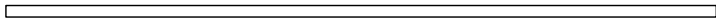

___ **A. (FRONT TRIM)** One (1) 3/4" X 1-1/2" X 40" Solid Wood

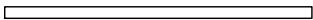

___ **B. (SIDE TRIM)** Two (2) 3/4" X 1-1/2" X 20" Solid Wood

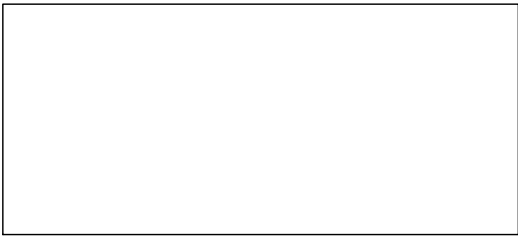

___ **C. (DESK TOP)** One (1) 3/4" X 20" X 38-1/2" Plywood

___ **D. WOOD GLUE:** One (1) 8 ounce bottle

___ **E. FINISH NAILS:** One (1) small box 1-1/2"

___ **F. VENEER OR MELAMINE TAPE:** 13/16" X 42"

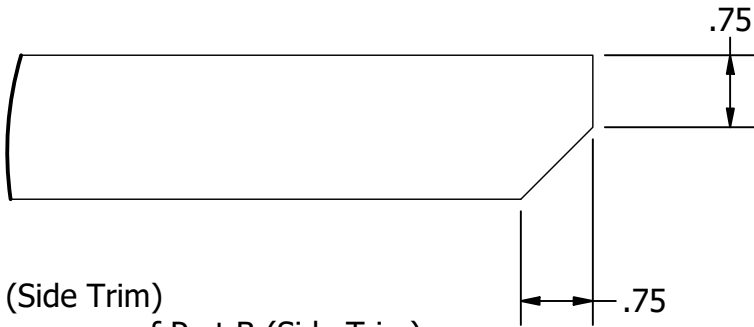

STEP 1: PART B (Side Trim)
Measure 3/4" from corner of Part B (Side Trim)
as shown. Next cut the corner off.

NOTE: For a finished look, apply wood veneer or melamine edge tape to the edge marked **(F)**.

STEP 2: Part B (Side Trim)

Run a bead of glue along inside edge. Making sure the ends are flush, with the 3/4" cutout in the back. Drill pilot holes approximately 5" apart and nail with 1-1/2" finish nails. Repeat Step 2 for other side, see below.

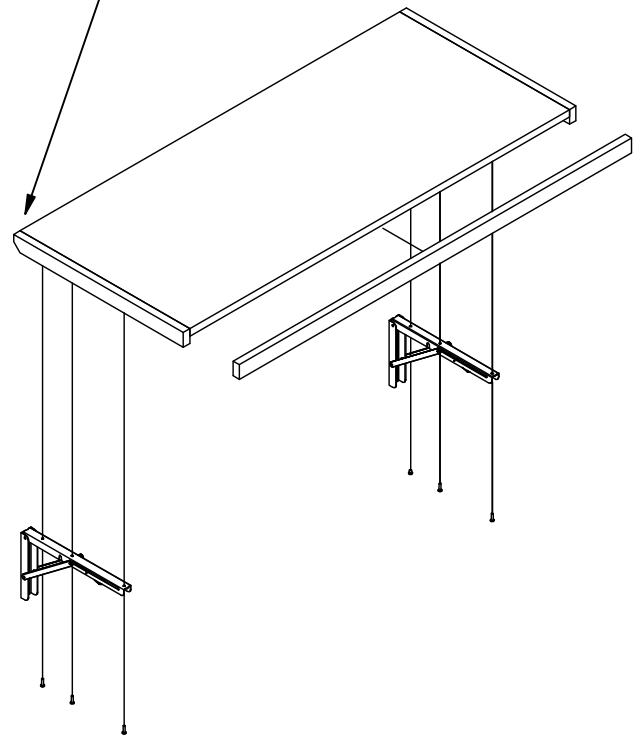
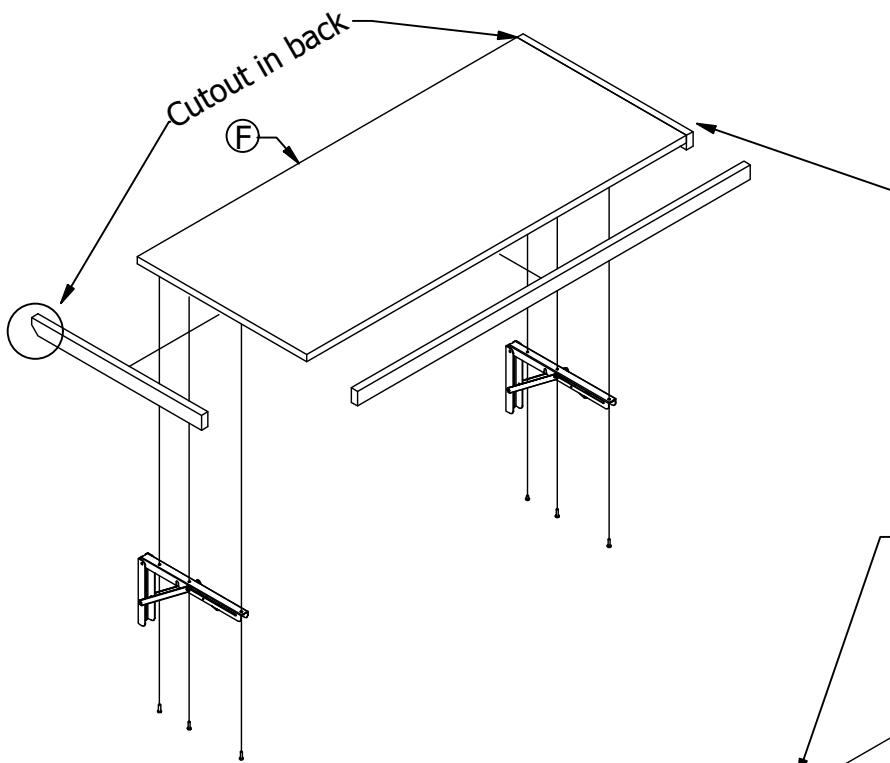

STEP 3: Part A (Front Trim)

Run a bead of glue along inside edge. Making sure the ends are flush with Parts B (Side Trim). Drill pilot holes approximately 8" apart and nail with 1-1/2" finish nails.

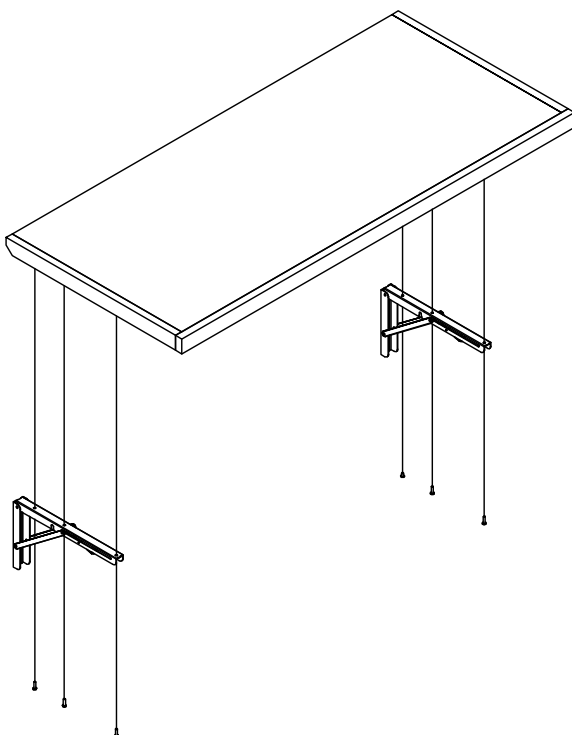

STEP 4: Sand & finish all components

Installing the Foldable Brackets

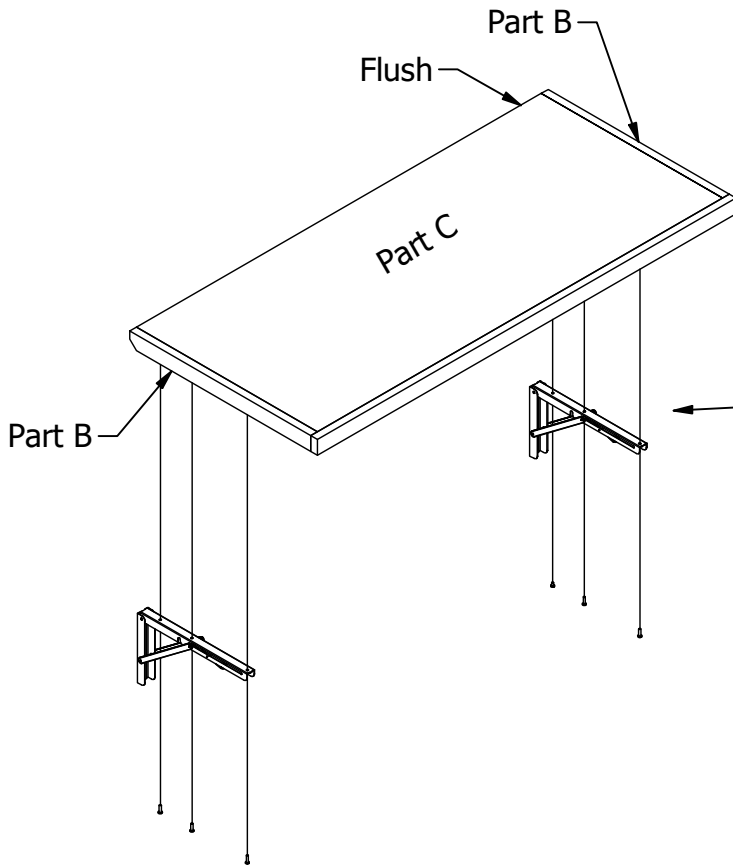

STEP 5: Place the Foldable Brackets to the bottom of Part C (Desk Top). Making sure the Foldable Brackets are **flush** to the back of Part C (Desk Top) and 1/4" gap between the Foldable Bracket and Part B (Side Trim).

STEP 6: Drill 3 pilot holes through the Foldable Brackets into Part C (Desk Top). Attach with three (3) #12 x 3/4" pan-head screws. Repeat Step 5 for other Foldable Bracket.

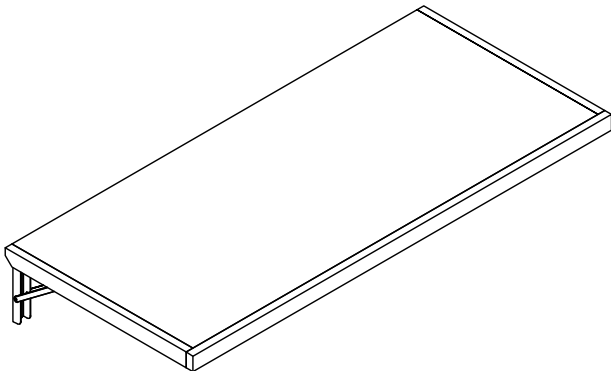
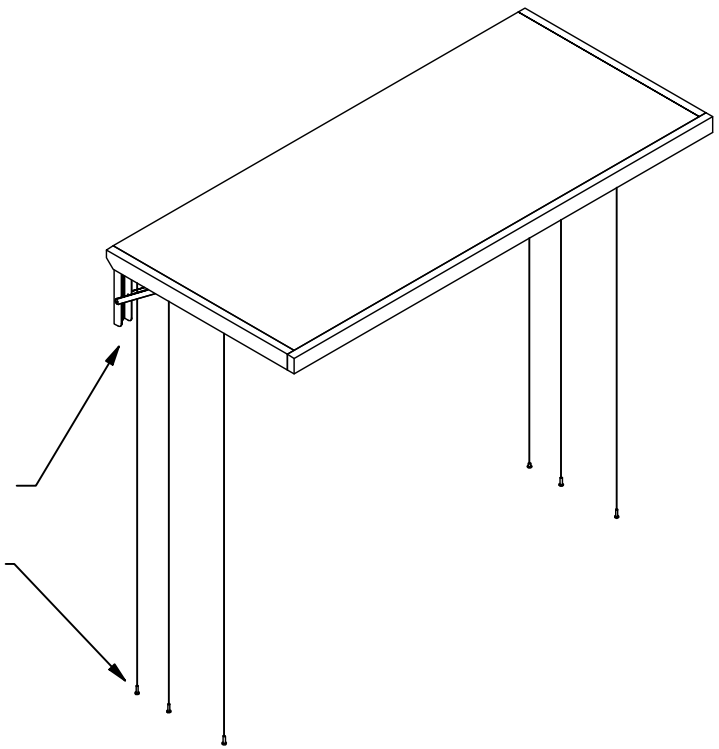

STEP 7: Measure up 30" from the floor and make a mark. This is to lineup the top edge of your desk.

Note: Make sure to center the desk on the face panel left to right.

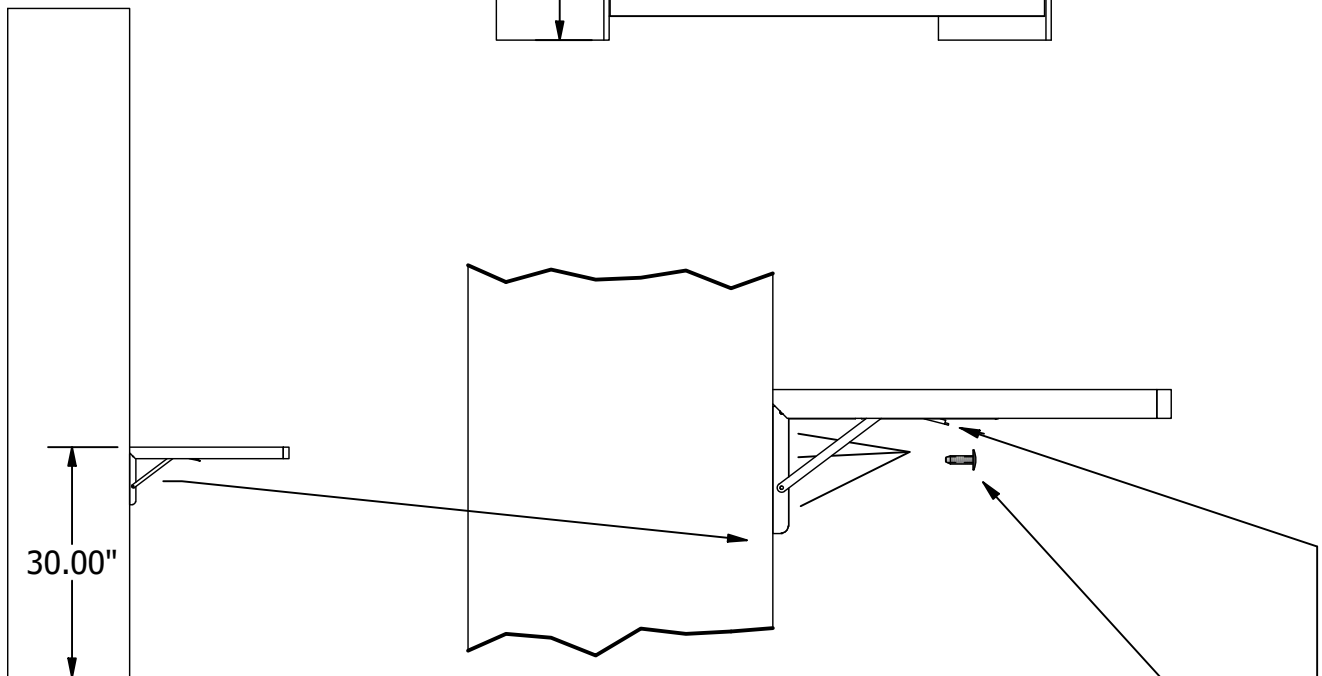
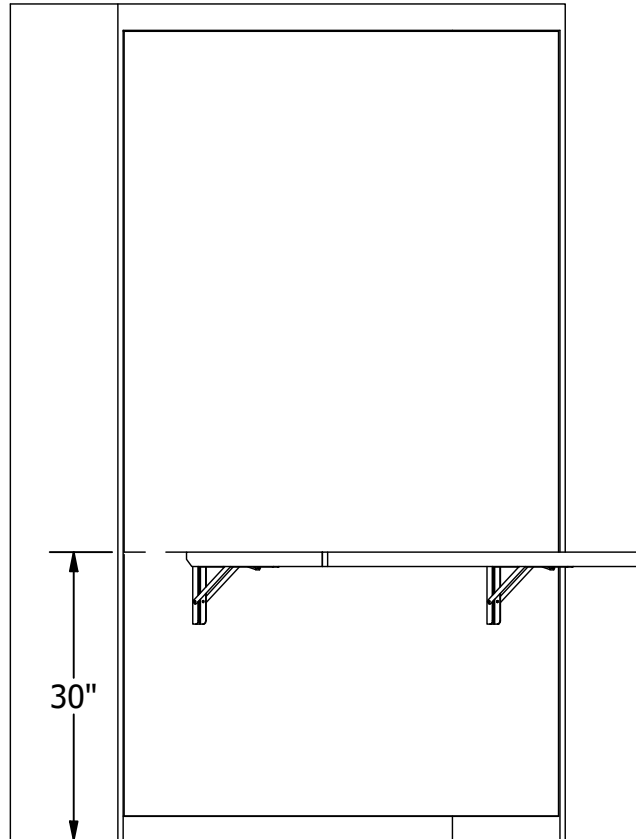

STEP 8: With a helper holding the desk level, drill pilot holes through the Foldable Brackets into the Face Panels. Attach with six (6) #12 x 3/4" pan-head screws.

STEP 9: Press the release lever and the desk top will fold down.

Place Heavy Duty Latches with Catch

PAGE 7

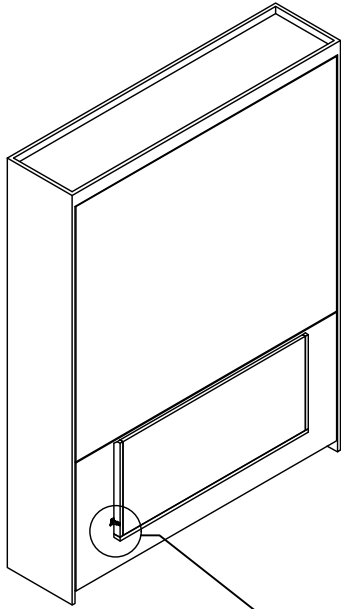

STEP 10: Measure up 4" from the bottom of Part A (Front Trim) and make a mark.

STEP 11: Connect the Heavy Duty Latch to the Catch. Line up your mark to the center hole on the Catch making sure the Heavy Duty Latch is touching the Part E (Face Panel) of the bed and pre drill for the Latch and Catch.

Note: The Catch will **not be flush** to the top edge of Part B (Side Trim)

STEP 12: Screw Two (2) 3/4" screws through the Latch into the Face Panel. Next screw 3/4" pan-head screw through the Catch. (Repeat steps 9, 10 and 11) on other side.

